

# Chobert® 1121



For installation information please refer to the tooling overview and manuals on our website [www.avdel-global.com](http://www.avdel-global.com).  
 Pour les conditions de pose, merci de vous référer à la description de l'outil et aux manuels disponibles sur notre site Web.  
 Angaben zur Verbeitung entnehmen Sie bitte der Geräteübersicht und den Betriebsanleitungen auf unserer Website.  
 Per informazioni sull'installazione, preghiamo consultare i manuali e la panoramica degli attrezzi sul nostro sito web.  
 Para ver información sobre máquinas de colocación, consulte nuestra página web, a partir de la visión general de máquinas y manuales.

English	Français	Deutsch	Italiano	Español
Dome head	Tête plate	Flachrundkopf	Testa tonda	Cabeza alomada
Low carbon steel*	Acier bas carbone*	Stahl*	Acciaio a basso tenore di carbonio*	Acero bajo en carbono*
Zinc plated	Revêtement zingué	Verzinkt	Zincato	Zincado
Clear trivalent passivated	Passivation claire trivalente	Klar chromatiert, Cr6-frei	Passivazione chiara trivalente	Pasivado claro trivalente

\*: SAE 1008 / EN 10263-2 C8C (DIN 10263-2 C8C, Qst 34-3)

## Option:

120° countersunk head. Replace part no. 01121 with 01122 for equivalent grip range. A, B and C dimensions may vary, details on request.  
 120° tête fraisée. Remplacer la série 01121 par 01122 avec plage de serrage équivalent. Dimensions A, B et C peut différer. Détails sur demande.  
 120° Senkkopf. Ersetzen Sie 01121 durch 01122 - bei äquivalentem Klemmbereich können Abmessungen A, B und C abweichen, Details auf Anfrage.  
 120° testa svasata: sostituire 01121 con 01122 per campo dello spessore serrabile equivalente. Dimensioni A, B e C possono variare. Dettagli su richiesta.  
 120° cabeza avellanada: cambiar 01121 por 01122 para espesores a remachar equivalente. Las dimensiones A, B y C pueden variar. Más información bajo petición.

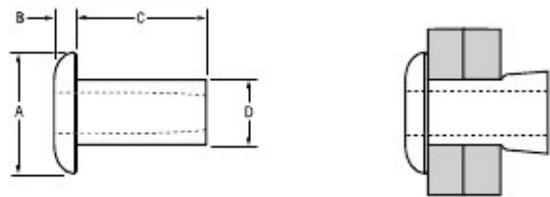

ø	[Diagram]		[Diagram]		A	B	C	D	[Diagram]	Fasteners per pod/ Nombre de rivets par chargeur / Niete pro Magazin/ Rivetti per carica- tore / Uds./carga	Part No/ref
	min.	max.	min.	max.							
3.2 (1/8")	0.00	1.57	3.26	3.34	5.2	1.2	3.2	3.25	1.4	71	01121-00404
	0.79	2.36					4.0			57	01121-00405
	1.57	3.18					4.8			51	01121-00406
	3.18	4.75					6.4			39	01121-00408
	4.75	6.35					7.9			32	01121-00410
	6.35	7.92					9.5			27	01121-00412
4.0 (5/32")	1.57	3.18	4.09	4.16	6.2	1.5	4.8	4.04	2.4	47	01121-00506
	3.18	4.75					6.4			38	01121-00508
	4.75	6.35					7.9			31	01121-00510
	6.35	7.92					9.5			27	01121-00512
	7.92	9.52					11.1			23	01121-00514
	9.52	11.10					12.7			21	01121-00516

all dimensions in mm / en millimètres / alle Maße in mm / in millimetri / en milímetros

1) typical values / valeurs moyennes / typische Werte / Valori tipici / resistencias máximas recomendadas

Avdel - Partner seit 1986



An Acument™ Global Technologies Company

[www.avdel-global.com](http://www.avdel-global.com)



© 2007 Acument Intellectual Properties, LLC

Chobert® is a trademark of Avdel UK Limited

04.2008, page 1/2

Data shown is subject to change without prior notice as a result of continuous product development and improvement policy.  
 Your local Avdel representative is at your disposal should you need to confirm latest information.

# Chobert® 1121

ø					A	B	C	D		Fasteners per pod/ Nombre de rivets par chargeur / Niete pro Magazin/ Rivetti per carica- tore / Uds./carga	Part No/ref
	nom.	min.	max.	min.	max.	± 0,3	max.	max.			
4.8 (3/16")	0.00	1.57	4.86	4.93	8.6	1.8	4.0	4.85	3.2	50	01121-00605
	1.57	3.18					5.6			38	01121-00607
	3.18	4.75					7.2			33	01121-00609
	4.75	6.35					8.8			28	01121-00611
	6.35	7.92					10.0			24	01121-00613
	7.92	9.52					12.0			21	01121-00615
	9.52	11.10					13.5			19	01121-00617
	11.10	12.70					15.1			17	01121-00619
6.4 (1/4")	3.18	4.75	6.36	6.42	10.2	2.1	7.2	6.35	4.4	32	01121-00809
	4.75	6.35					8.8			27	01121-00811
	6.35	7.92					10.0			24	01121-00813
	7.92	9.52					12.0			21	01121-00815
	9.52	11.10					13.5			19	01121-00817
	11.10	12.70					15.1			17	01121-00819

all dimensions in mm / en millimètres / alle Maße in mm / in millimetri / en milímetros

1) typical values / valeurs moyennes / typische Werte / Valori tipici / resistencias máximas recomendadas

# Chobert® 1131



For installation information please refer to the tooling overview and manuals on our website [www.avdel-global.com](http://www.avdel-global.com).  
 Pour les conditions de pose, merci de vous référer à la description de l'outil et aux manuels disponibles sur notre site Web.  
 Angaben zur Verbeitung entnehmen Sie bitte der Geräteübersicht und den Betriebsanleitungen auf unserer Website.  
 Per informazioni sull'installazione preghiamo consultare i manuali e la panoramica degli attrezzi sul nostro sito web.  
 Para ver información sobre máquinas de colocación, consulte nuestra página web, a partir de la visión general de máquinas y manuales.

English	Français	Deutsch	Italiano	Español
Dome head	Tête plate	Flachrundkopf	Testa tonda	Cabeza alomada
Aluminium alloy* (3.5 % Mg)	Alliage d'aluminium* (3.5% Mg)	Aluminium* (3.5 % Mg)	Lega di alluminio* (3.5% Mg)	Aluminio* (3.5% Mg)
Natural	Brut	Blank	Nessuna finitura	Natural

\*: BS 1473 5154A DIN 1725 AlMg3.5 Werkstoff 3.3535

#### Options:

2.5 % Mg aluminium alloy: replace part no. 01131 with 01125, please note reduction in shear strength, details on request.  
 120° countersunk head: replace part no. 01131 with 01132 for equivalent grip range. A, B and C dimensions may vary, details on request.  
 2.5 % Mg alliage d'aluminium: remplacer la série 01131 par 01125, veuillez respecter réduction en cisaillement, détails sur demande.  
 120° tête fraisée: remplacer la série 01131 par 01132 avec plage de serrage équivalent. Dimensions A, B et C peut différer. Détails sur demande.  
 2.5 % Mg Aluminium-Legierung: ersetzen Sie 01131 durch 01125, bitte beachten Sie eine Reduktion der Scherfestigkeit, Details auf Anfrage.  
 120° Senkkopf: ersetzen Sie 01131 durch 01132 - bei äquivalentem Klemmbereich können Abmessungen A, B und C abweichen, Details auf Anfrage.  
 2.5 % Mg lega di alluminio: sostituire 01131 con 01125, notare la riduzione della resistenza a taglio, Dettagli su richiesta.  
 120° testa svastata: sostituire 01131 con 01132 per campo dello spessore serrabile equivalente. Dimensioni A, B e C possono variare. Dettagli su richiesta.  
 Aluminio (2,5 % de Mg): cambiar 01131 por 01125, obsérvese la reducción en la resistencia a la cortadura. Más información bajo petición.  
 120° cabeza avellanada: cambiar 01131 por 01132 para espesores a remachar equivalente. Las dimensiones A, B y C pueden variar. Más información bajo petición.

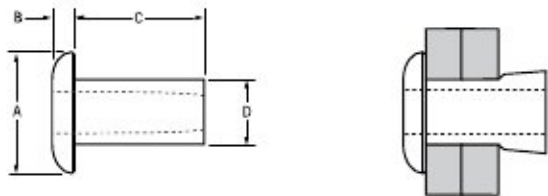

ø	Ø		Ø		A	B	C	D	kN <sup>1)</sup>	Fasteners per pod / Nombre de rivets par chargeur / Niete pro Magazin / Rivetti per carica- tore / Uds./carga	Part No/ref
	min.	max.	min.	max.							
2.4 (3/32")	0.00	1.57	2.49	2.55	± 0.3 4.0	max. 1.0	3.17	2.48	0.5	73	01131-00304
	1.57	3.17					4.75			52	01131-00306
	3.17	4.75					6.35			41	01131-00308
	4.75	6.35					7.92			33	01131-00310
	6.35	7.92					9.52			28	01131-00312
	7.92	9.52					11.10			24	01131-00314
	9.52	11.10					12.70			22	01131-00316
3.2 (1/8")	0.00	1.57					3.28			3.34	± 0.3 5.2
	1.57	3.17	4.75	51	01131-00406						
	3.17	4.75	6.35	39	01131-00408						
	4.75	6.35	7.92	32	01131-00410						
	6.35	7.92	9.52	27	01131-00412						

all dimensions in mm / en millimètres / alle Maße in mm / in millimetri / en milímetros

1) typical values / valeurs moyennes / typische Werte / Valori tipici / resistencias máximas recomendadas

**Avdel - Partner seit 1986**



An Acument™ Global Technologies Company

[www.avdel-global.com](http://www.avdel-global.com)



© 2007 Acument Intellectual Properties, LLC

Chobert® is a trademark of Avdel UK Limited

11a.2007, page 1/2

Data shown is subject to change without prior notice as a result of continuous product development and improvement policy.  
 Your local Avdel representative is at your disposal should you need to confirm latest information.

# Chobert® 1131

ø					A	B	C	D		Fasteners per pod/ Nombre de rivets par chargeur / Niete pro Magazin/ Rivetti per carica- tore / Uds./carga	Part No/ref
	nom.	min.	max.	min.							
4.0 (5/32")	1.57	3.17	4.09	4.16	6.2	1.5	4.75	4.06	1.6	47	01131-00506
	3.17	4.75					6.35			38	01131-00508
	4.75	6.35					7.92			31	01131-00510
	6.35	7.92					9.52			27	01131-00512
	7.92	9.52					11.10			23	01131-00514
	9.52	11.10					12.70			21	01131-00516
	0.00	1.57					4.85			4.93	8.6
1.57	3.17	5.56	38	01131-00607							
3.17	4.75	7.14	33	01131-00609							
4.75	6.35	8.74	28	01131-00611							
6.35	7.92	10.31	24	01131-00613							
7.92	9.52	11.91	21	01131-00615							
9.52	11.10	13.49	19	01131-00617							
11.10	12.70	15.09	17	01131-00619							
3.17	4.75	6.35	6.42	10.2	2.2	7.14		6.32	2.7		
4.75	6.35					8.74	27			01131-00811	
6.35	7.92					10.31	24			01131-00813	
7.92	9.52					11.91	21			01131-00815	
9.52	11.10					13.49	19			01131-00817	
11.10	12.70					15.09	17			01131-00819	
12.70	14.27					16.66	16			01131-00821	
14.27	15.87					18.26	14			01131-00823	
15.87	17.45					19.84	13			01131-00825	

all dimensions in mm / en millimètres / alle Maße in mm / in millimetri / en milímetros

1) typical values / valeurs moyennes / typische Werte / Valori tipici / resistencias máximas recomendadas



An Acument™ Global Technologies Company

www.avdel-global.com

Chobert® is a trademark of Avdel UK Limited

Avdel - Partner seit 1986



© 2007 Acument Intellectual Properties, LLC

Data shown is subject to change without prior notice as a result of continuous product development and improvement policy.  
Your local Avdel representative is at your disposal should you need to confirm latest information.

11a.2007, page 2/2

# Chobert® 1143



For installation information please refer to the tooling overview and manuals on our website [www.avdel-global.com](http://www.avdel-global.com).

Pour les conditions de pose, merci de vous référer à la description de l'outil et aux manuels disponibles sur notre site Web.

Angaben zur Verarbeitung entnehmen Sie bitte der Geräteübersicht und den Betriebsanleitungen auf unserer Website.

Per informazioni sull'installazione, preghiamo consultare i manuali e la panoramica degli attrezzi sul nostro sito web.

Para ver información sobre máquinas de colocación, consulte nuestra página web, a partir de la visión general de máquinas y manuales.

English	Français	Deutsch	Italiano	Español
Dome head	Tête plate	Flachrundkopf	Testa tonda	Cabeza alomada
Brass*	Laiton*	Kupfer-Zink Legierung*	Ottone*	Latón*
Electro tin plated**	Etamage électrolytique**	verzinkt**	Stagnato**	Estañado electrolítico**

\*: BS EN 12166 CW 508L DIN 17660 CuZn37

\*\* : Avdel recommends tin plated parts are installed within nine months from the date they were produced / Avdel conseille d'utiliser les pièces en laiton étamé sous un délai de 9 mois après la date de production / Avdel empfiehlt, verzinnte Niete innerhalb 9 Monaten nach Produktionsdatum zu verarbeiten / Avdel raccomanda di utilizzare i prodotti stagnati entro nove mesi a decorrere dalla data di fabbricazione / Avdel recomienda utilizar sus piezas estañadas antes de nueve meses desde la fecha de su fabricación.

Option:

For brightened Brass finish replace 01143 with 01141 / Pour finition brillante remplacer la série 01143 par 01141 / Für Oberfläche blank ersetzen Sie 01143 durch 01141 / Per finitura brillante sostituire 01143 con 01141 / Con acabado brillante cambiar 01143 por 01141

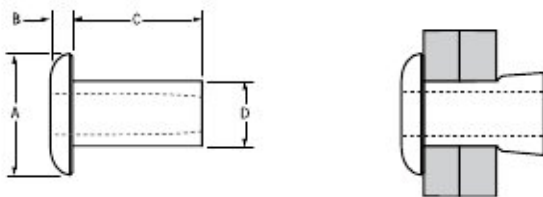

ø	[Cross-section diagram]		[Thread diagram]		A	B	C	D	[Torque diagram]	Fasteners per pod/ Nombre de rivets par chargeur / Niete pro Magazin/ Rivetti per carica- tore / Uds./carga	Part No/ref
	nom.	min.	max.	min.							
2.4 (3/32")	0.00	1.57	2.49	2.55	4.0	1.0	3.2	2.48	0.6	73	01143-00304
	1.57	3.17					4.8			52	01143-00306
	3.17	4.75					6.4			41	01143-00308
	4.75	6.35					8.0			33	01143-00310
	6.35	7.92					9.6			28	01143-00312
3.2 (1/8")	0.00	1.57	3.28	3.34	5.2	1.2	3.2	3.25	1.1	71	01143-00404
	1.57	3.17					4.8			51	01143-00406
	3.17	4.75					6.4			39	01143-00408
	4.75	6.35					8.0			32	01143-00410
4.0 (5/32")	1.57	3.17	4.09	4.16	6.2	1.5	4.8	4.06	1.8	47	01143-00506
	3.17	4.75					6.4			38	01143-00508
	4.75	6.35					8.0			31	01143-00510
	6.35	7.92					9.6			27	01143-00512
	7.92	9.52					11.1			23	01143-00514
	9.52	11.10					12.7			21	01143-00516
4.8 (3/16")	1.57	3.17	4.85	4.93	8.6	1.8	5.6	4.82	2.5	38	01143-00607
	3.17	4.75					7.2			33	01143-00609
	4.75	6.35					8.8			28	01143-00611
	6.35	7.92					10.4			24	01143-00613
	7.92	9.52					12.0			21	01143-00615
	9.52	11.10					13.5			19	01143-00617

all dimensions in mm / en millimètres / alle Maße in mm / in millimetri / en milímetros

1) typical values / valeurs moyennes / typische Werte / Valori tipici / resistencias máximas recomen

Avdel - Partner seit 1986



An Acument™ Global Technologies Company

[www.avdel-global.com](http://www.avdel-global.com)

Chobert® is a trademark of Avdel UK Limited

Data shown is subject to change without prior notice as a result of continuous product development and improvement policy. Your local Avdel representative is at your disposal should you need to confirm latest information.

